

HB 20

Profilbiegeapparat, Montage auf Tisch
 Profile bending machine, for table mounting

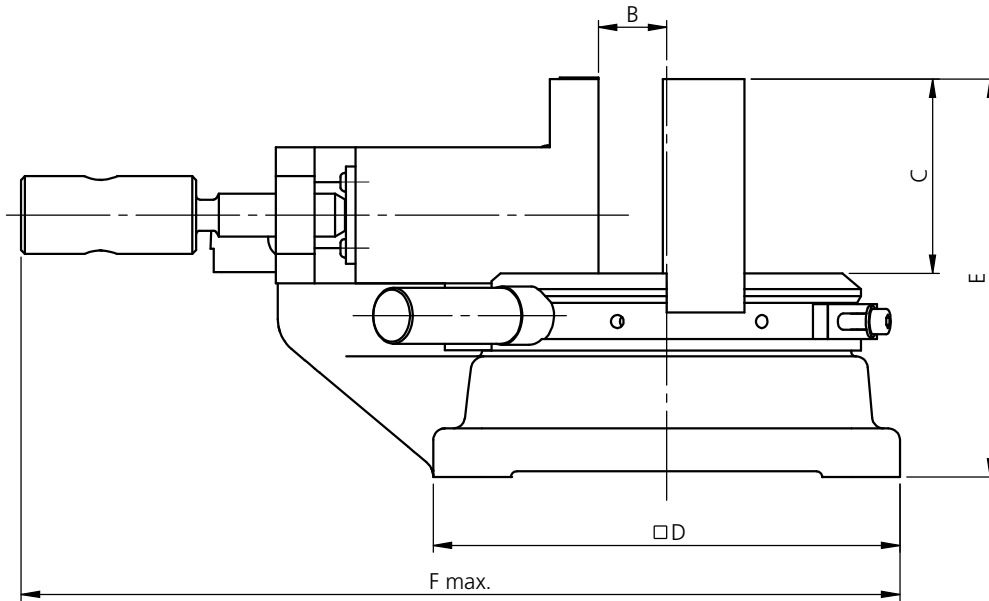
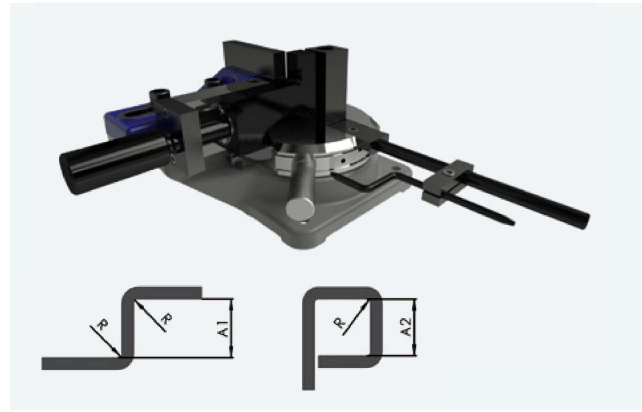

| Typ | Type | B | C | D | E | F | Masse (mm) | Dimensions (mm) |
|-------|------|----|-----|-----|-----|-----|------------|-----------------|
| HB 20 | | 40 | 100 | 240 | 205 | 465 | | |

| Typ | Beschreibung | Gewicht | Lieferumfang | Bestell-Nr. |
|-------|--|---------|---|----------------|
| Type | Description | Weight | Delivery details | Order No. |
| HB 20 | Profilbiegeapparat, Montage auf Tisch Profile bending machine, for table mounting | 43.9 | Biegewerkzeug R=2 mm, 90° Winkel- und Längenanschlag Bedienhebel 2-teilig Bending tool R=2 mm, 90° Material stop and angle stop Bending lever 2-part | HBM.020.000.01 |

| Max. Biegeleistung Max. bending performance | | |
|---|-------------------|--------|
| Dimension | Stahl warmgewalzt | Kupfer |
| Dimensions | Steel hot rolled | Copper |
| mm | 1.0038 (RSt37-2) | |
| | 100×7 | 100×8 |
| | 80×8 | 80×10 |
| | 50×10 | 50×12 |
| | 35×12 | 30×15 |
| | 18×18 | 20×20 |
| | ø18 | ø20 |
| ** 4 | 25×1.5 | 25×2 |
| | ø4 | ø5 |
| ** 6 | 25×2 | 25×2.5 |
| | ø6 | ø7 |
| ** 8 | 25×3 | 25×3.5 |
| | ø8 | ø9 |

| Lieferbare Biegewerkzeuge Available bending tools | | | | |
|---|---------------|--------------|-------------------|----|
| Biegeradius | Biegewinkel | Spannöffnung | Mindestabstände | |
| Bending radius | Bending angle | Jaw opening | Minimum clearance | |
| R | ° | B | A1 | A2 |
| 0 | 90° | 40 | 30 | 40 |
| 2 | 90° | 38 | 34 | 44 |
| 5 | 90° | 35 | 40 | 50 |
| 8 | 90° | 32 | 46 | 56 |
| 10 | 180° | 30 | 50 | 20 |
| 15 | 180° | 25 | 60 | 30 |
| 20 | 180° | 20 | 70 | 40 |
| 25 | 180° | 15 | 80 | 50 |
| ** 4 | 180° | 36 | 38 | 8 |
| ** 6 | 180° | 34 | 42 | 12 |
| ** 8 | 180° | 21 | 46 | 16 |

** Biegewerkzeuge 180° für kleine Radien, Biegehöhe C = max. 25 mm, reduzierte Biegeleistung
 ** Bending tools 180° for small radius, bending height C = max. 25 mm, reduced bending performance